

# Styertowne Shopping Center

Route 3 and Bloomfield Avenue  
Clifton, New Jersey



# Styertowne SC

Clifton, New Jersey

Available: Up to 2,670 S.F.  
**NOW OPEN! Planet Fitness & Phenix Salon**

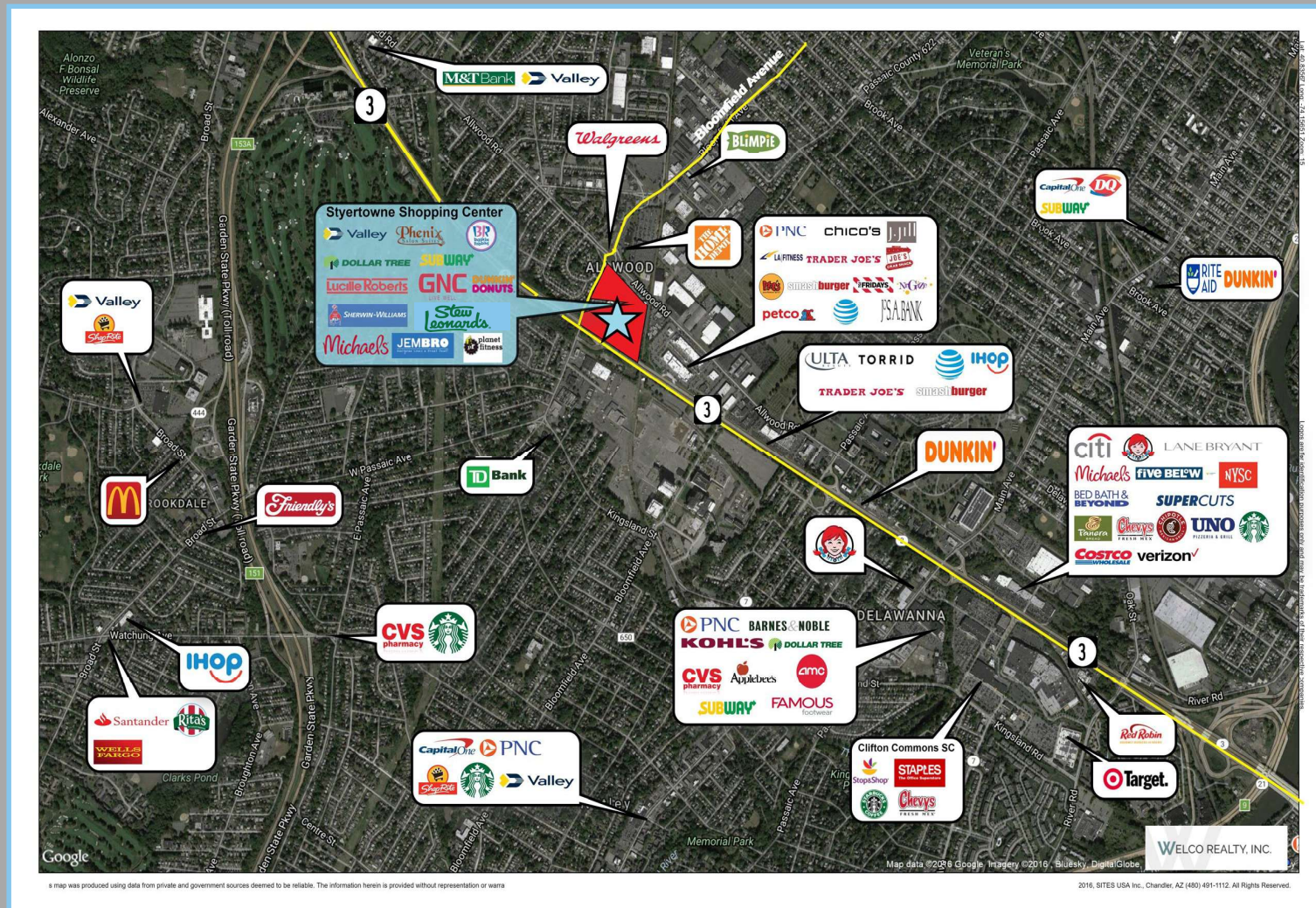

Great access from Allwood Road & Route 3.

Styertowne Shopping Center is situated in the heart of the Route 3 corridor, just 1 mile from the Garden State Parkway, exit 153, 3 miles from the New Jersey Turnpike, exit 16W, and the Meadowlands Sports Complex.



Just across the street from Home Depot & minutes from Barnes & Noble, Kohl's, Staples, Torrid, Target & AMC Theater.

Join Stew Leonard's, Dollar Tree, Planet Fitness, Phenix Salon Suites, Jembro, Michael's, GNC & Sherwin Williams.



Demographics:	3 Miles	5 Miles
Population	260,541	647,355
Households	91,567	238,571
Avg HH Inc.	\$151,604	\$139,236
Avg Age	37.5	37.9
Average Daily Traffic	110,867	

**AVAILABLE SPACES:** Space # 10 - 1,318 s.f.  
Space # 11 - 1,352 s.f.

**SPACES CAN BE COMBINED FOR A TOTAL OF 2,670 S.F.**



WELCO REALTY, INC. · 2525 Palmer Avenue, New Rochelle, NY 10801 · T (914) 576-7500 / Fax: 7596 · [www.welcorealty.com](http://www.welcorealty.com)

All information is from sources believed reliable and has not been independently verified. No representation is made to the accuracy of information herein, which is subject to errors, omissions and modifications. Licensed in New York, New Jersey, Connecticut & Pennsylvania.

# Styertowne Shopping Center - Clifton, New Jersey



AVAILABLE: 1,318 s.f. & 1,352 s.f. (Spaces 10 & 11 can be combined for a total of 2,670 s.f.)

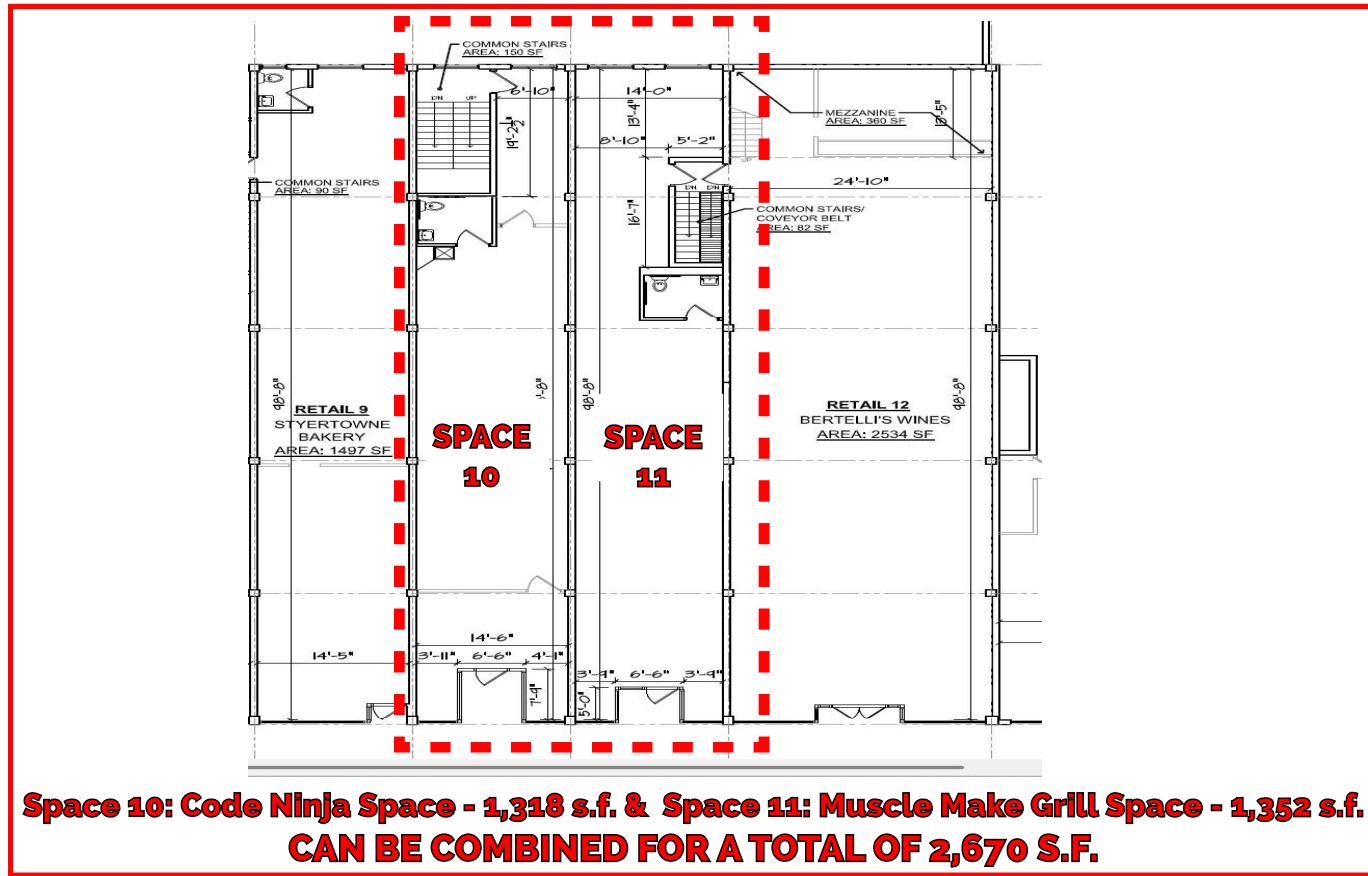

Tenant Roster (and GLA)			
1	Valley National Bank		3,000
2	Chiropractic Center		1,919
3	Kim's Nails		921
4	Cleaners 2000		845
5	Post Office		3,680
6	CVS Pharmacy		12,840
7	JEMBRO		5,000
8	Subway		1,500
9	Styertowne Bakery		1,500
10	<b>Code Ninja - Available</b>		<b>1,318</b>
11	<b>Muscle Maker Grill - Available</b>		<b>1,352</b>
12	Urgent Care		2,604
13	Dollar Tree		
	Ground Floor		11,056
	Upper Level		11,175
14	Diamond Braces		3,235
15	Corbo Jewelers		2,500
16	GNC		2,500
17	Clifton Physical Therapy		2,500
18	Bitol Mexican Restaurant		2,000
19	In Sight Eye & Vision Care*		2,048
20	Taste of Tuscany Restaurant *		1,240
21	Leased *		500
22	Antonio's Hair Salon *		593
23	Dayton Confectionery *		1,540
24	Dunkin Donuts *		2,142
25	Largo House Spa *		3,600
26	Allstate		850
27	Snipes		7,000
28	Planet Fitness (1st level) **		6,000
	Upper Level		15,000
29	Phenix Salon Suites (Lower Level)		14,000
30	Stew Leonard's		54,609
31	Sherwin Williams *		4,000
32	Michael's		21,000
33	Swim Club *		9,100

\* Lower Level

\*\* Space 28 has dedicated elevator and staircase.

