

Elwood Shopping Center  
Jericho Turnpike  
East Northport, New York

East Northport, NY  
Elwood Shopping Center  
Up to 14,903 s.f. Available

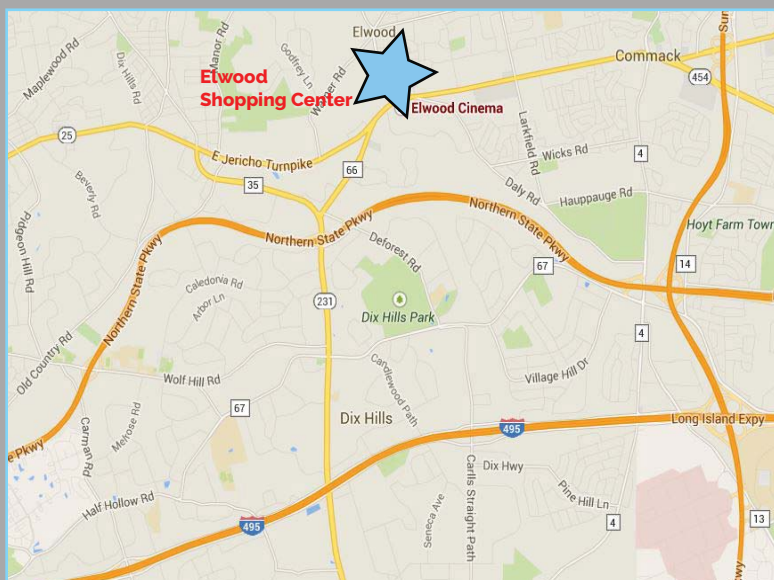

Demographics	1 mile	3 miles	5 miles
Population	6,253	71,923	213,899
Households	2,087	24,836	73,262
Average HH Income	\$183,920	\$177,883	\$168,354
Median Age	44.3	44.5	43.2



Available: 600 s.f. / 1,380 s.f. / 7,560 s.f. / 14,903 s.f.  
 Major Tenants: Pet Supplies Plus, Lux Eye Care Studio, Huntington Learning Center, Eastern Market Farms, Wayback Burgers, Denny's, & Go Health Urgent Care.  
 Parking: 425 parking spaces





### Tenants

1. Available (former Annie Sez)	14,903 sf
2. Pet Supplies Plus	10,300 sf
3. Victoria Nail & Spa	3,000 sf
4. Eastern Market Farms	6,500 sf
5. Elwood Cinema - AVAILABLE	7,560 sf
6. Available	600 sf
7. Lux Eye Care Studio	1,485 sf
8. Denny's	7,500 sf
9. Hibachi	5,500 sf
10. Graffiti	4,100 sf
11. Huntington Learning Center	3,000 sf
12. Nu-Clear Cleaner/Tailor	1,100 sf
13. Lonny's	1,500 sf
13a. Blow Me Away	1,500 sf
14. First Class Bagels	4,000 sf
15. Pico Tequila	1,906 sf
16. AVAILABLE	1,380 sf
17. OM Beauty	870 sf
18. True North Urgent Care	2,975 sf
19. Jake's Hamburgers	2,015 sf
20. Snip-its	1,500 sf
21. American Community Bank	3,003 sf

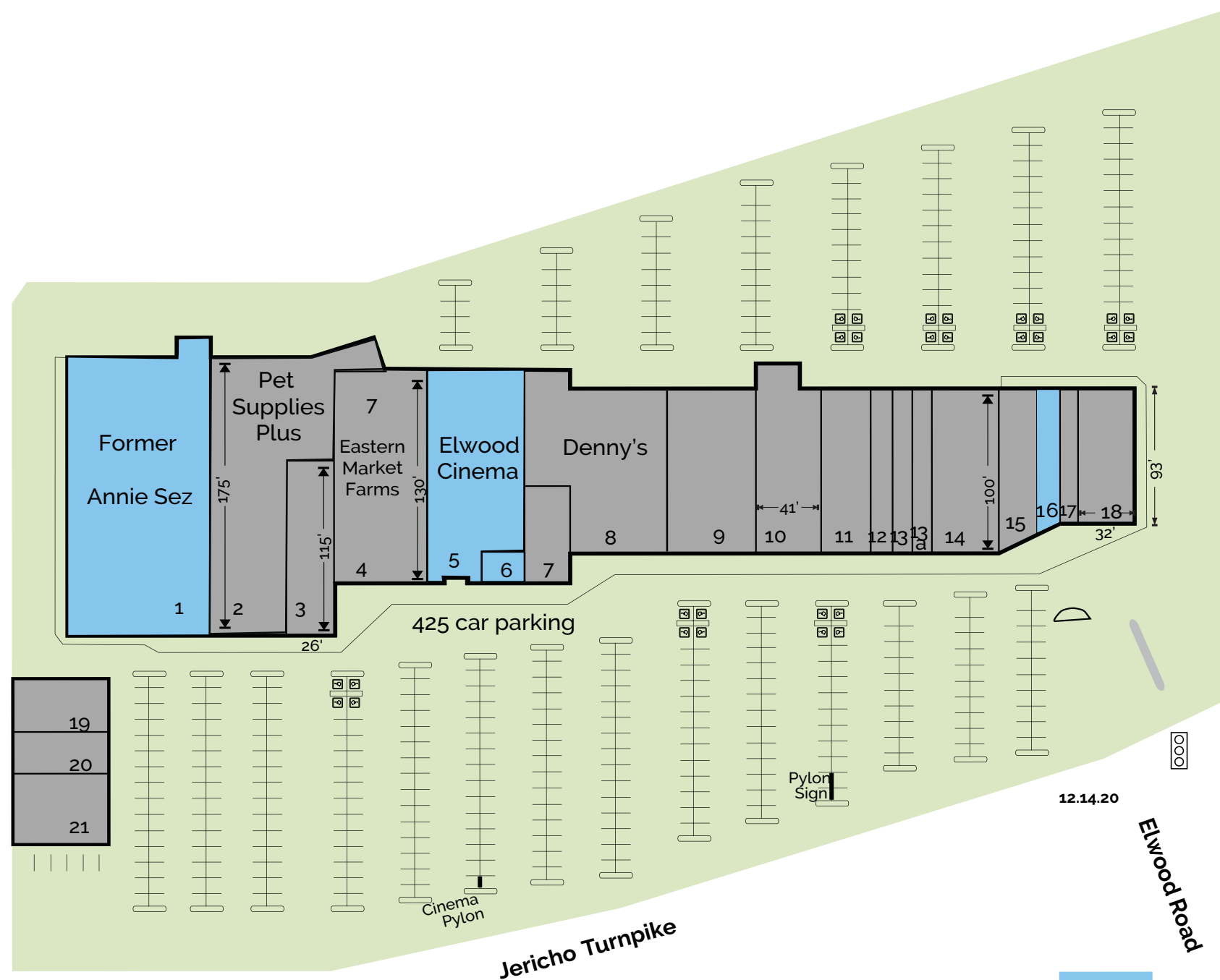

This site plan is for location purposes only. Dimensions are approximate. Not to scale.

AVAILABLE -  

### Location

Jericho Turnpike & Elwood Road  
off of Deer Park Road  
East Northport,  
Suffolk County, New York

### Access

Jericho Turnpike,  
Long Island Expressway,  
Northern State Parkway

### Type

Neighborhood  
Shopping Center

### Parking

425 Spaces

### GLA

86,000 ± Square Feet

- The Township of Huntington, with its beautiful beaches and waterways, quaint villages and thriving business and retail community, is home to more than 190,000 people.
- More than 45,000 people work in the area for such major companies as Bank of America, Nikon, Estee Lauder, General Accident Insurance, Underwriters Lab, Newsday and many more.
- Jericho Turnpike (car traffic count of approximately 40,000) runs east/west and is lined with shops, national chains, department stores, discount stores and restaurants.
- Elwood Shopping Center, newly renovated, is strategically located as the first retail center on the east-bound side of Jericho Turnpike at Elwood Road.