

Elwood Shopping Center Jericho Turnpike East Northport, New York

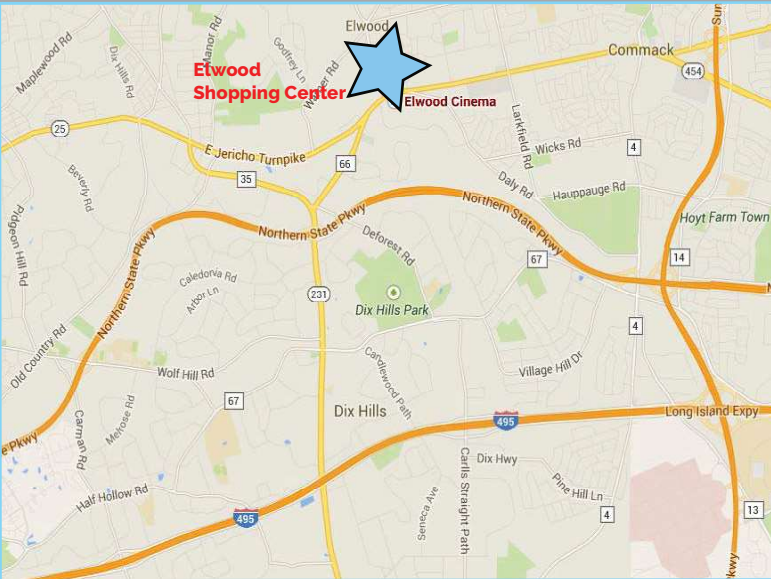

Demographics	1 mile	3 miles	5 miles
Population	6,253	71,923	213,899
Households	2,087	24,836	73,262
Average HH Income	\$183,920	\$177,883	\$168,354
Median Age	44.3	44.5	43.2

OWNED & MANAGED BY
treeco

East Northport, NY Elwood Shopping Center Up to 7,500 s.f. Available



Available: 1,500 s.f. & 7,500 s.f.

Major Tenants: Retro Fitness, Pet Supplies Plus, Huntington Learning Center, Caggiano's Gourmet Market, Wayback Burgers, & True North Urgent Care.

Parking: 425 parking spaces



WELCO REALTY, INC. • 2525 Palmer Avenue, New Rochelle, NY 10801 • T (914) 576-7500 / Fax: 7596 • www.welcorealty.com

All information is from sources believed reliable and has not been independently verified. No representation is made to the accuracy of information herein, which is subject to errors, omissions and modifications. Licensed in New York, New Jersey, Connecticut & Pennsylvania.

East Northport / Commack, New York

Elwood Shopping Center - Jericho Turnpike - Up to 7,500 s.f. Available



Suite No.	Tenant Name	SF
1	Retro Fitness	14,903
2	Pet Supplies Pus	10,300
3	Victoria Nail & Spa	3,000
4	Eastern Meat Farms	6,500
5	True North Urgent Care	7,560
6	Chip City	600
7	Lux Eye Care	1,485
8	Available	7,500
9	Hotoke Sushi & Hibachi	5,500
10	Lease Out	4,100
11	Huntington Learning Center	3,000
12	Nu-Clear Cleaner / Tailor	1,100
13	Blow Me Away Salon	1,500
13 a	Available	1,500
14	First Class Bagels	4,000
15	Pico Tequila Grill	1,906
16	Carvel	1,380
17	Threading Salon	870
18	Vio Med Spa	2,975
19	Wayback Burger	2,015
20	Snip-its	1,500
21	Lease Out	3,003

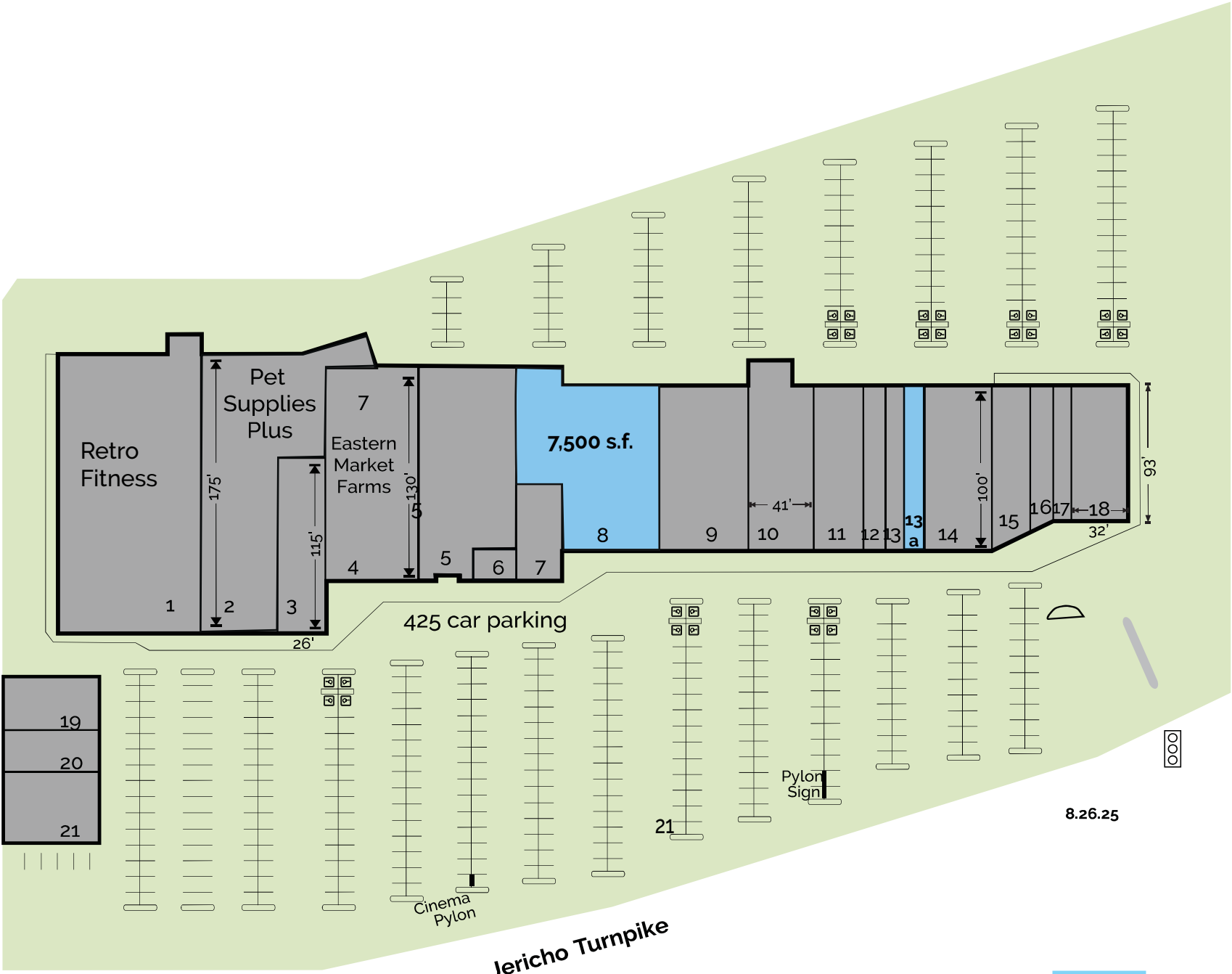

This site plan is for location purposes,only
Dimensions are approximate. Not to scale.

Location	Access	Type	Parking	GLA
Jericho Turnpike & Elwood Road off of Deer Park Road East Northport, Suffolk County, New York	Jericho Turnpike, Long Island Expressway, Northern State Parkway	Neighborhood Shopping Center	425 Spaces	86,000 ± Square Feet

- The Township of Huntington, with its beautiful beaches and waterways, quaint villages and thriving business and retail community, is home to more than 190,000 people.
- More than 45,000 people work in the area for such major companies as Bank of America, Nikon, Estee Lauder, General Accident Insurance, Underwriters Lab, Newsday and many more.
- Jericho Turnpike (car traffic count of approximately 40,000) runs east/west and is lined with shops, national chains, department stores, discount stores and restaurants.
- Elwood Shopping Center, newly renovated, is strategically located as the first retail center on the east-bound side of Jericho Turnpike at Elwood Road.